

Custom Brick Order Form

My brick request is for the:
_____ Cabin Patio "Brick for Bricks"

Print legibly the **name, date or message** for your brick (up to 3 lines and 13 characters per line). You will be contacted for confirmation.

_____ Memorial Butterfly Garden Pathway
Review the purpose of the Memorial Garden Pathway, and attach a written statement of your loved one's contributions to Hidden Valley Camp. Include as many details as possible, as this may serve as a foundation for their biography. A picture may be requested.

Print legibly the **name only** (up to 3 lines and 13 characters per line). You will be contacted for confirmation.

Contact: _____

Phone #: (____) _____

Email: _____

Full Address: _____

Minimum donation per brick:

\$100 / \$50 for DG Girl Scout troops

Troop #: _____

I have enclosed \$_____, payable by check to:

**Friends of Hidden Valley, PO Box 442073,
Lawrence, KS 66044**

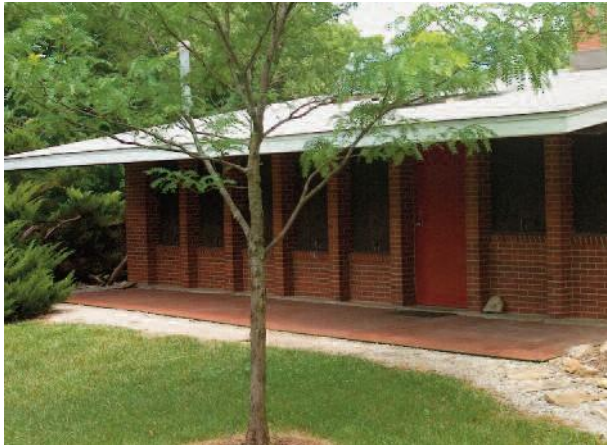

A Brick for Bricks

Ar-ca-loo-ka Cabin Patio Brick Fundraising Project

In celebration of the 100th year of Girl Scouting in 2012, an ongoing fundraising project was begun at Ar-ca-loo-ka Cabin. Now you can honor a leader or your own Girl Scout, recognize your parents or troop, create a memorial brick for a loved one, or leave your own mark on Hidden Valley! ANYONE can now order a custom-inscribed brick for placement in the south cabin patio AND help support Hidden Valley Camp in this exciting new fundraising project! Our first phase of fundraising through 2014 enabled us to replace the brick chimney of the cabin. Our second phase will help us build a large outdoor fireplace/cooking grill at Southern Shade Shelter. Fill out the attached order form today!

Brick orders will be accepted year round, with ordering and placement completed on an annual basis. Please note that weather and time may cause cracks to occur; bricks are not guaranteed and cannot be replaced without charge. Bricks are the property of Lawrence Hidden Valley Camp.

Memorial Pathway Bricks and A Brick for Bricks

Fundraising Projects for
Lawrence Hidden Valley Camp

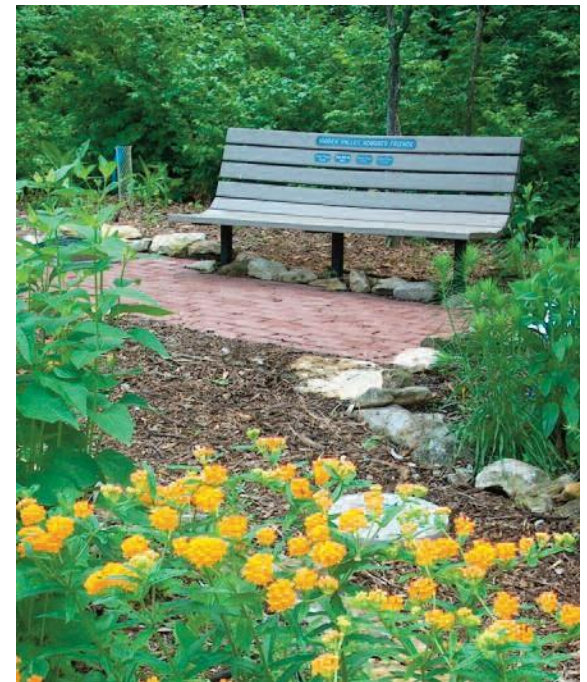

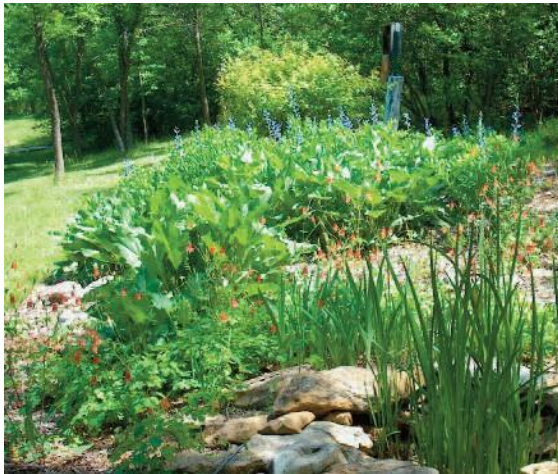

The Friends Memorial Butterfly Garden of Hidden Valley Camp

was first **dedicated in June, 2000**. Planted entirely with native wildflowers, grasses, and shrubs, the garden has served many purposes:

- benefits our native wildlife friends, particularly birds and butterflies
- provides educational hands-on experiences as youth explore and study the flowers and insects
- serves as a sensory garden, full of texture, color, size, fragrance, and even sound
- the Honored Friends Bench in the center of the garden recognizes living volunteers that have made an impact
- provides a tranquil setting for reflective thinking and enjoyment in a peaceful, natural setting

Memorial Pathway

Honoring our Past

Ten years later, The Memorial Brick Pathway was created within the garden to connect us to our past and a place to learn about our history and the legacy of our volunteers of Hidden Valley Camp. Each inscribed brick serves as a link from the past to the present and to the future, as we continue to add the names of our most significant contributors and volunteers. Dedicated during Day Camp on June 16, 2011, the following excerpts of a reading say it all:

“...think of Hidden Valley as a flowering Daisy. The stems, strong and holding everything upright, are like the buildings and roads.

The green leaves, which gather and distribute energy from the sun, are like today’s volunteers, as they work to make sure there is enough food, energy and equipment for the girls to enjoy.

The flowers are the girls, bright and dancing in the sun. They are our future, they hold the seeds.

There is another part of the plant you cannot see; it is our past. The roots of the daisy are like those volunteers who built this place, raised funds and spent endless hours working to make sure you have what you need. Their work is now done, and they have passed on, but it is by their caring and their efforts that we are sustained today. We need all the parts of the daisy plant. It is through the dedication of the Brick Memorial Pathway that we may honor and remember our roots, where we came from.”

-- Brick Memorial Pathway Dedication 2011



The Purpose of the Memorial Pathway

is to recognize by name our most wonderful and committed volunteers of the past. A Memorial Notebook, residing in the cabin, describes each person’s contributions, while also providing a historical perspective of the camps development.

If you would like to purchase an inscribed brick in memory of a loved one, please consider the purpose of the memorial brick pathway. Some examples of significant contributions are below:

- Served multiple terms on the Lawrence Hidden Valley Committee (LHVC) and/or Friends of Hidden Valley (FHV) board
- A longtime volunteer at the camp
- A Lifetime Member of FHV or a generous benefactor
- A long-serving Douglas County Girl Scout leader that made Hidden Valley an integral part of her troop’s activities, instilling a love of nature and stewardship ideals to her scouts.